

文件类型 内部发行文件

MARK	DATE	ECN NO.	DESCRIPTION	REV.	DESIGN
△					

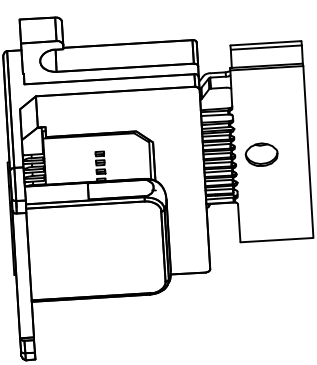
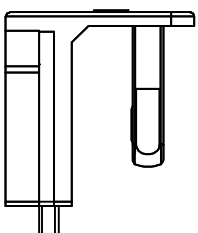
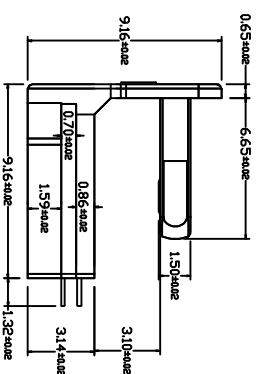
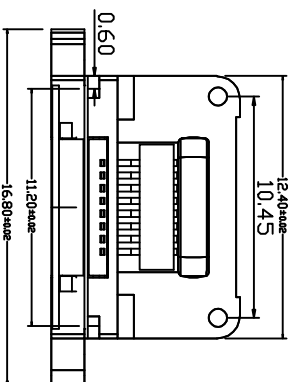
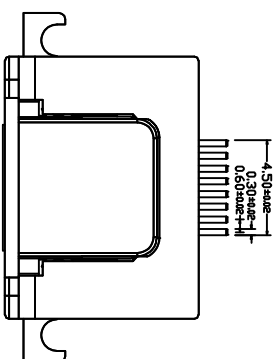
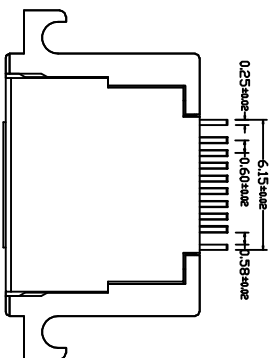

注意! 8P 公头材质为黄铜电镀3U,

10P 母座材质为磷铜电镀1U,

外壳为锌合金电镀珍珠镍,

嵌芯为LCP料加工时请勿超过260°

深圳市顺宏康科技有限公司

密焊脚3, 1 公母一体

SHK-20156

UNLESS OTHERWISE SPECIFIED TOLERANCE			
ANG	TOL	DIM	TOL
.X	±3.0°	.X	±0.10
.XX	±2.0°	.XX	±0.05
.XXX	±1.0°	.XXX	±0.03

DRAW NO.	DESIGN	DATE	TITLE	UNITS	SCALE	PAGE	REV
	VERIFIED		PART NO.	mm	1:1	1/1	A
	APPROVED						