

RECOMMENDED P.C.B PATTERN LAYOUT

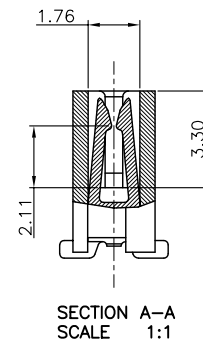

SECTION A-A SCALE 1:1

CKTS	DIM A	DIM B	DIM C	DIM D
4	3.00	5.14	3.90	6.50
5	4.00	6.14	4.90	7.50
6	5.00	7.14	5.90	8.50
7	6.00	8.14	6.90	9.50
8	7.00	9.14	7.90	10.50
9	8.00	10.14	8.90	11.50
10	9.00	11.14	9.90	12.50
11	10.00	12.14	10.90	13.50
12	11.00	13.14	11.90	14.50
13	12.00	14.14	12.90	15.50
14	13.00	15.14	13.90	16.50
15	14.00	16.14	14.90	17.50
16	15.00	17.14	15.90	18.50
17	16.00	18.14	16.90	19.50
18	17.00	19.14	17.90	20.50
19	18.00	20.14	18.90	21.50
20	19.00	21.14	19.90	22.50
21	20.00	22.14	20.90	23.50
22	21.00	23.14	21.90	24.50
23	22.00	24.14	22.90	25.50
24	23.00	25.14	23.90	26.50
25	24.00	26.14	24.90	27.50
26	25.00	27.14	25.90	28.50
27	26.00	28.14	26.90	29.50
28	27.00	29.14	27.90	30.50
29	28.00	30.14	28.90	31.50
30	29.00	31.14	29.90	32.50

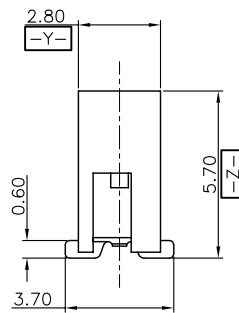
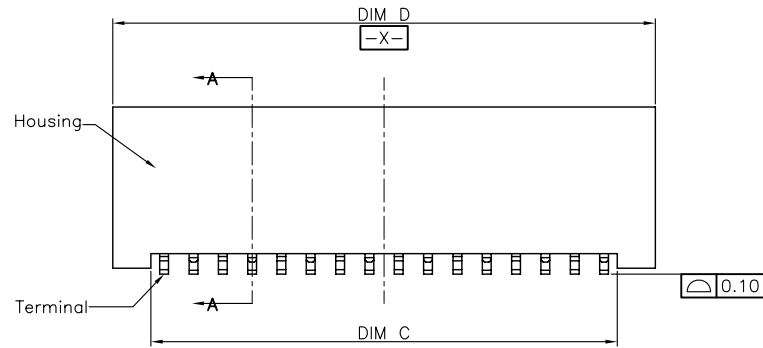
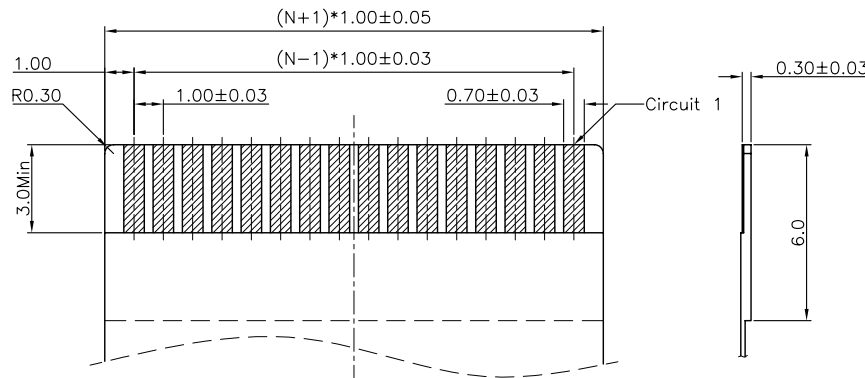
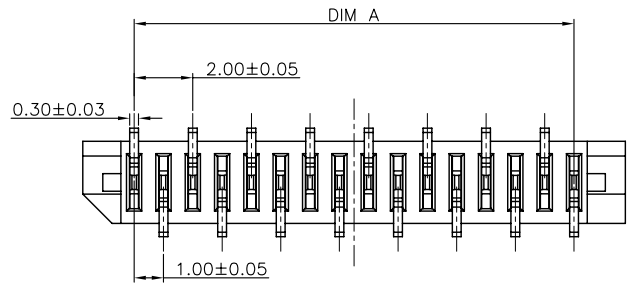

RECOMMENDED FPC/FFC DIMENSION

- Note:
- Material:
 - Housing: thermoplastic high temp. UL94V-0; Color: natural.
 - Terminal: copper alloy T=0.30mm.
 - Finish:
 - Terminal: Underplating: matt Tin overall.
 - Product must comply HF RoHS specification.

PART NO. SPEC
AF2D XX R * S O T 1 0_Q0

NO. OF CKTS
CONTACT TYPE
R:180° SMT Normal
L:180° SMT Reverse
PACKING CODE
P:Tape & Reel
T:Tube

PLATING CODE
0:MATT-Tin 90-120u"
1:GOLD FLASH 1u"
2:GOLD FLASH 2u"
3:GOLD FLASH 3u"
A:Point Gold-plated 1u"
B:Point Gold-plated 2u"
C:Point Gold-plated 3u"

深圳市顺宏康科技有限公司

CUSTOMER DRAWING

Tolerance unspecified (未注公差)	Size (图幅): A4	Product Name (产品名称):
0.0 ±0.15 0° ±5°	Unit (单位): MM	1.0Pitch H=5.7 FPC Non-ZIF CONN. S/A SMT Normal B Type
0.00 ±0.10 0° 0 ±3°	Scale (比例): 1:1	Product No (产品料号):
0.000 ±0.05 0° 00 ±1°	Page (页数): 1 OF 1	AF2DXXR*SOT10_Q001 SHK-10288
Project View (投影视角)	Designer (设计): Steven 12/23'11	Checked (审核): Allan 12/23'11
Rev (版本):	Rev (版本): A	Approved (核准):

Rev	Change Description	Date	Revisor
1	初版发行	2011/12/23	Allan
2	变更内容		